



## TS-231 // TEMPERATURE WIFI SENSOR MODULE - 1 NTC

Accurate and Precise Measuring

Wifi Communication

Long Operating Life

Easy Assembling

IP 67 Plastic Case



Sensor cable length can be changed (0-10m) according to demand  
Metal probe length can be selected as 50mm or 100mm.

### TECHNICAL SPECIFICATIONS

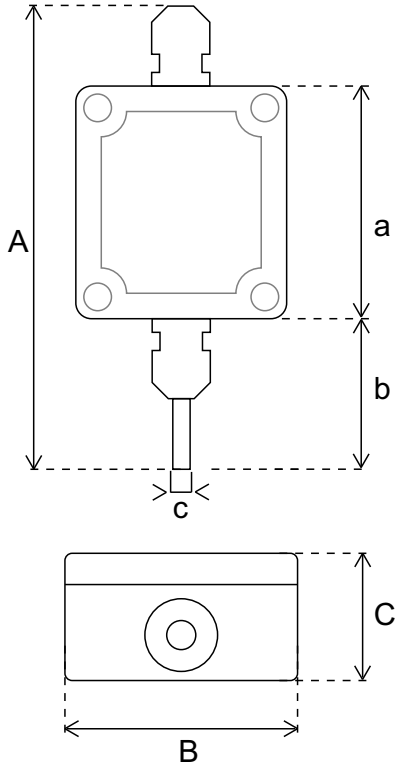

#### Product Informations

Product Name	TS-231 Temperature Wifi Sensor Module - 1 NTC
Input	12 V DC
Communication	Wifi 2.4 GHz

Sensor	Measuring Range	Sensitivity	Accuracy
Temperature	0 - 50°C / (-20) - (+80)°C	± 0,1 °C	± 0,5 °C

#### Dimensions

A	B	C	a	b	c
135 mm	58 mm	35 mm	64 mm	50 mm	6 mm