

M-011 // MASTER MAIN MODULE

Easy Installation

WIFI / GSM Communication

RF Communication

Long Communication Range

IP 67 Plastic Case

Temperature & Humidity Sensor (Optional)



TECHNICAL SPECIFICATIONS

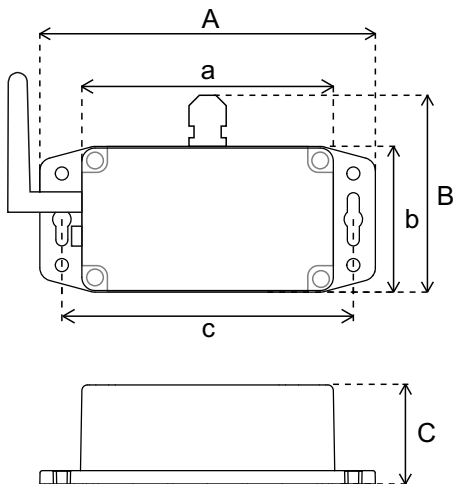

Product Informations

Product Name	M-011 Master Main Module
Input	12 V DC
Communication	433 Mhz RF Wireless Communication Wifi 2.4 Ghz GSM M2M 2G

Sensor	Measuring Range	Sensitivity	Accuracy
Temperature	0 - 50°C / (-20) - (+80)°C	± 0,1 °C	± 0,3 °C
Humidity	0 - 100 %	± % 1	± % 3

Dimensions

A	B	C	a	b	c
152 mm	87 mm	60 mm	115 mm	65 mm	133 mm